

HAMILTON COUNTY INDIANA

2024-2028

CONSOLIDATED PLANNING PROCESS

Presented by:

Noblesville Housing Authority

Prosperity Indiana

Usona Development LLC



THE CDBG “WHAT”

Community Development Block Grants (CDBG)

- HUD funding to entitled cities and counties distributed on a formula basis.
 - Principal Cities in MSA
 - Metro cities with population > \$50,000
 - Counties with population > 200,000 - excluding entitled cities.

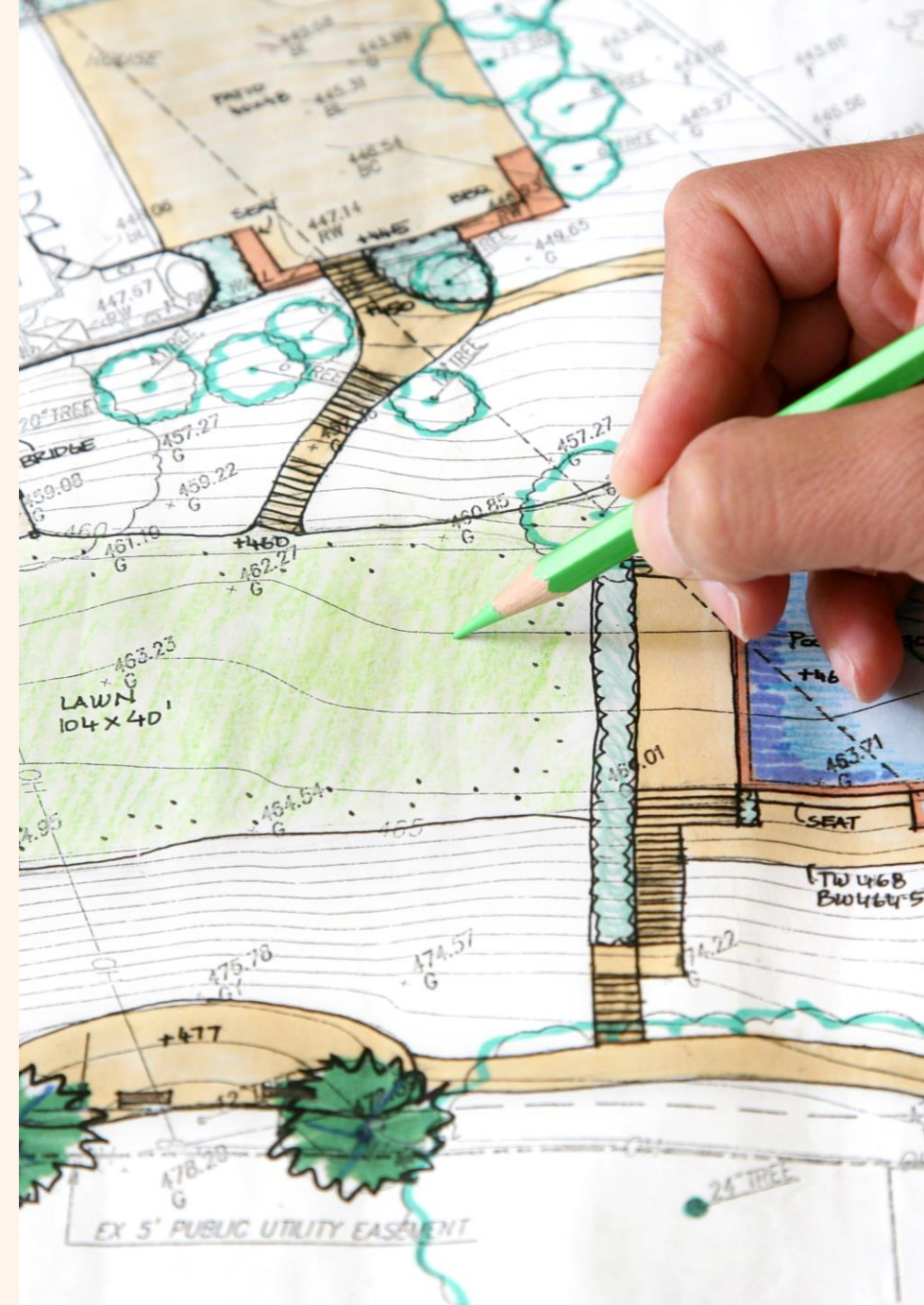

THE CDBG “WHAT”

Purpose/ Use of Funds

- National Objectives
 1. Benefit LMI populations
 2. Aid in prevention of slums or blight
 3. Meet other urgent community development needs

- Use of Funds
 - Acquisition of property/demolition
 - Rehab (homes and facilities)
 - Construction of public facilities and improvements
 - Public services
 - Energy conservation/renewable energy resources
 - Assistance to profit-motivated businesses

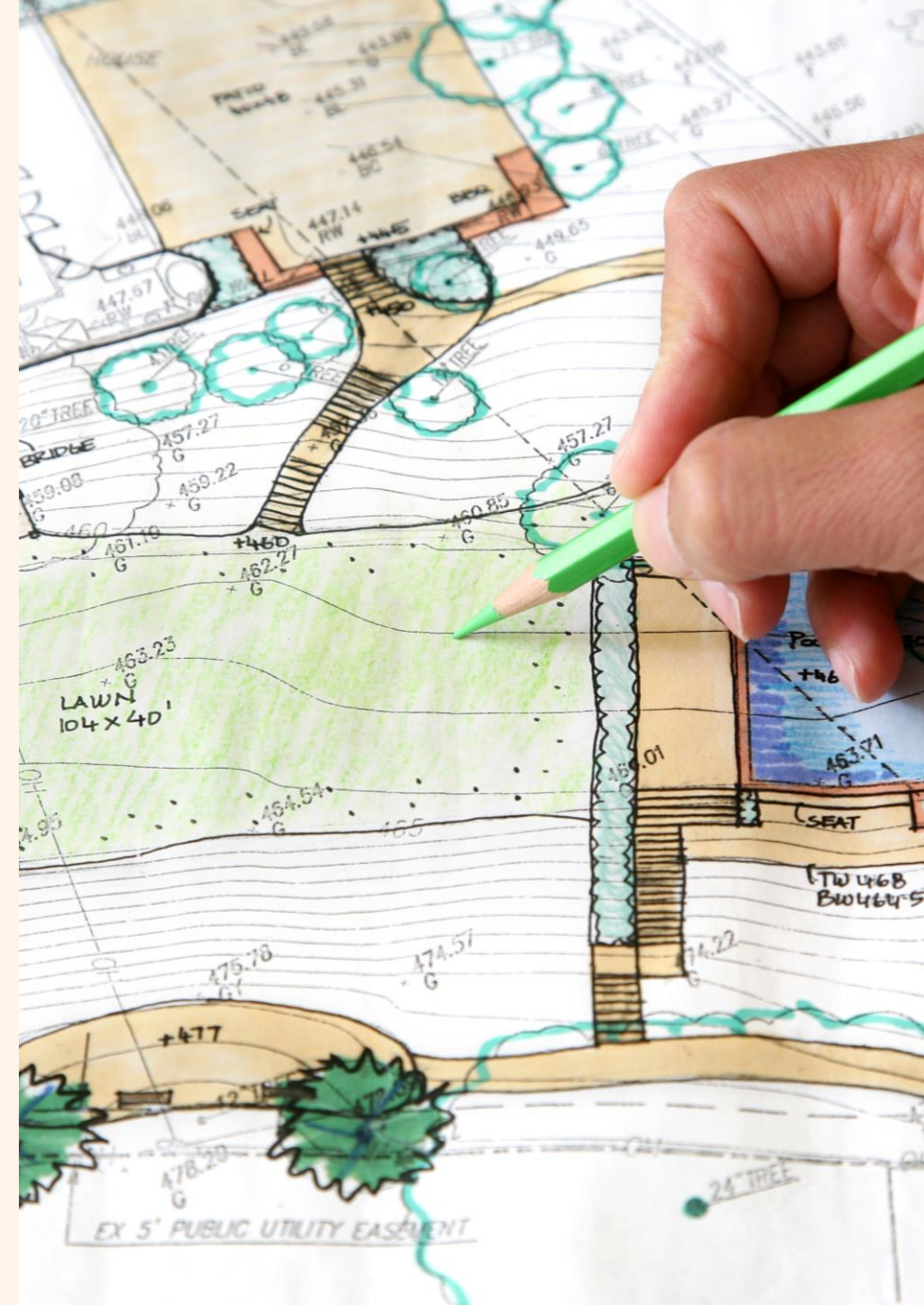

THE CDBG “WHAT”

Citizen Participation

1. The Consolidated Plan identifies a community's priority needs in the areas of community development and affordable housing and proposes strategies on how to best use the resources available to meet those needs.
2. The Consolidated Plan is an application for Community Development Block Grant (CDBG), a grant designed to meet the needs of low- and moderate-income residents.

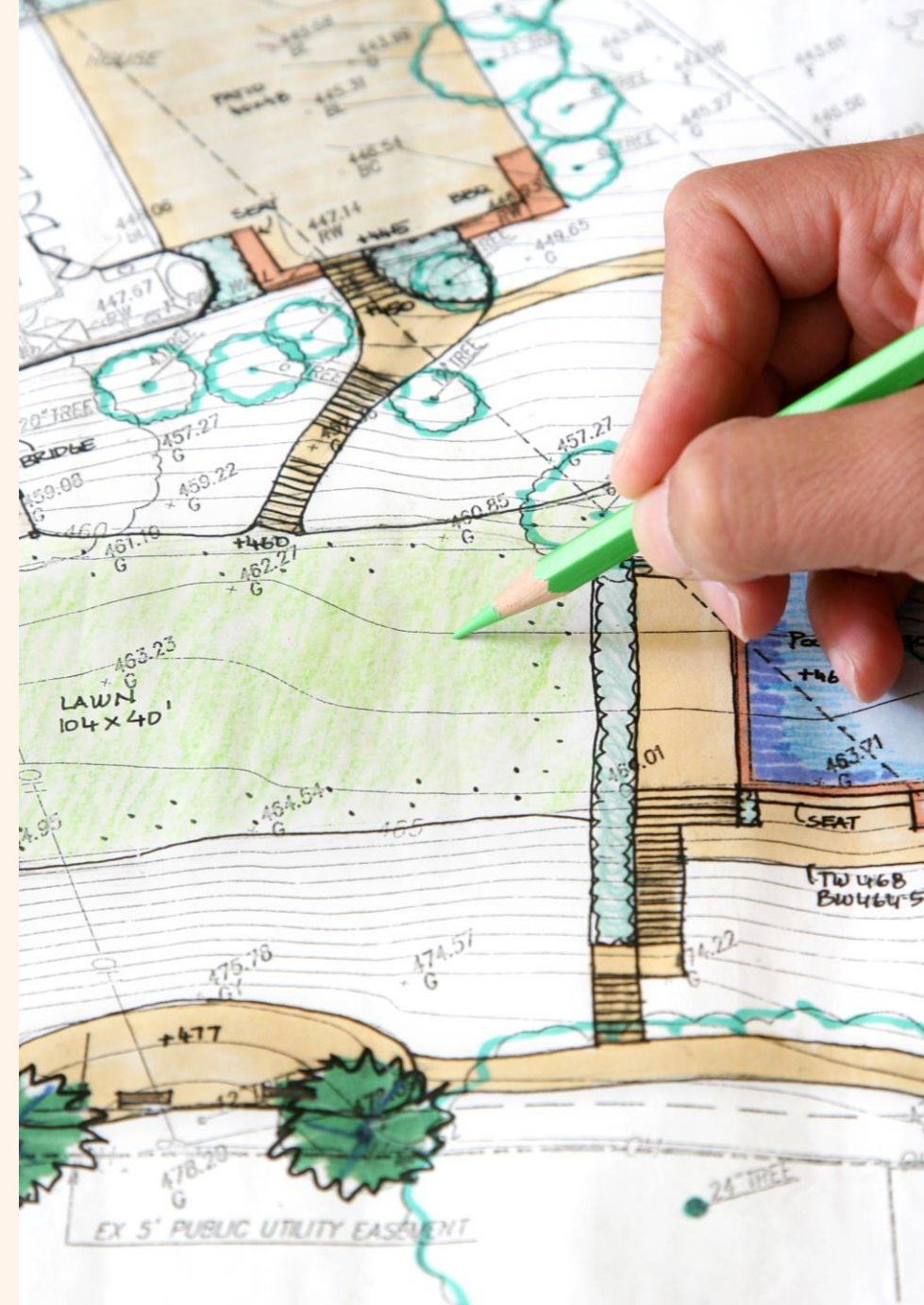



HAMILTON COUNTY PLAN

The Planning Process

- Public Participation
- Consultations

Summary of Data and Market

- Housing and Assisted Housing
- Community Facilities

Strategic Plan

- Priorities
- Resources

Annual Action Plan

HAMILTON COUNTY DATA

CDBG funds are meant to help working-class families and households earning less than 80% of the area's median income.

- 30,675 households (1 of every 4) qualify for assistance – per HUD CHAS data
- Includes firefighters (\$59,550), kindergarten teachers (\$57,900), machinists (\$47,560) and office clerks (\$41,910) – per BLS.

Hamilton County Indiana Income Limits					
Income Limit	Household Size				
	1	2	3	4	5
30% AMI	20,300	23,200	26,100	29,000	31,350
50% AMI	33,850	38,700	43,550	48,350	52,250
80% AMI	54,150	61,900	69,650	77,350	83,550

CDBG ELIGIBLE AREAS

Percent of Population qualified as Low Mod Income

- < 38%
- 38 to 51%
- 51 to 77%

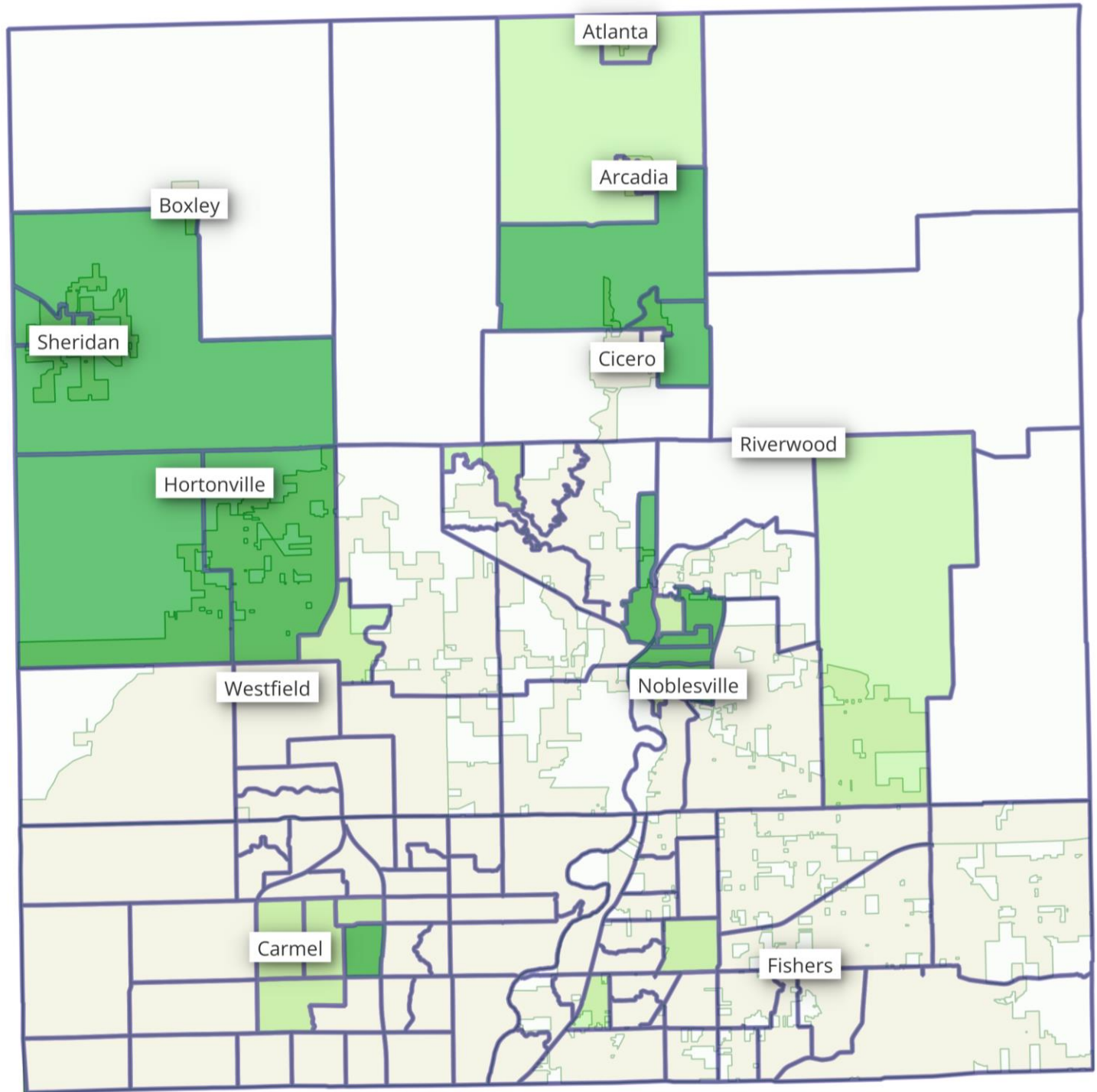

POVERTY IN HAMILTON CO

Hamilton County Poverty

 Townships

 Streets

Poverty Rate

 > 10%

Source 2016-2020 ACS

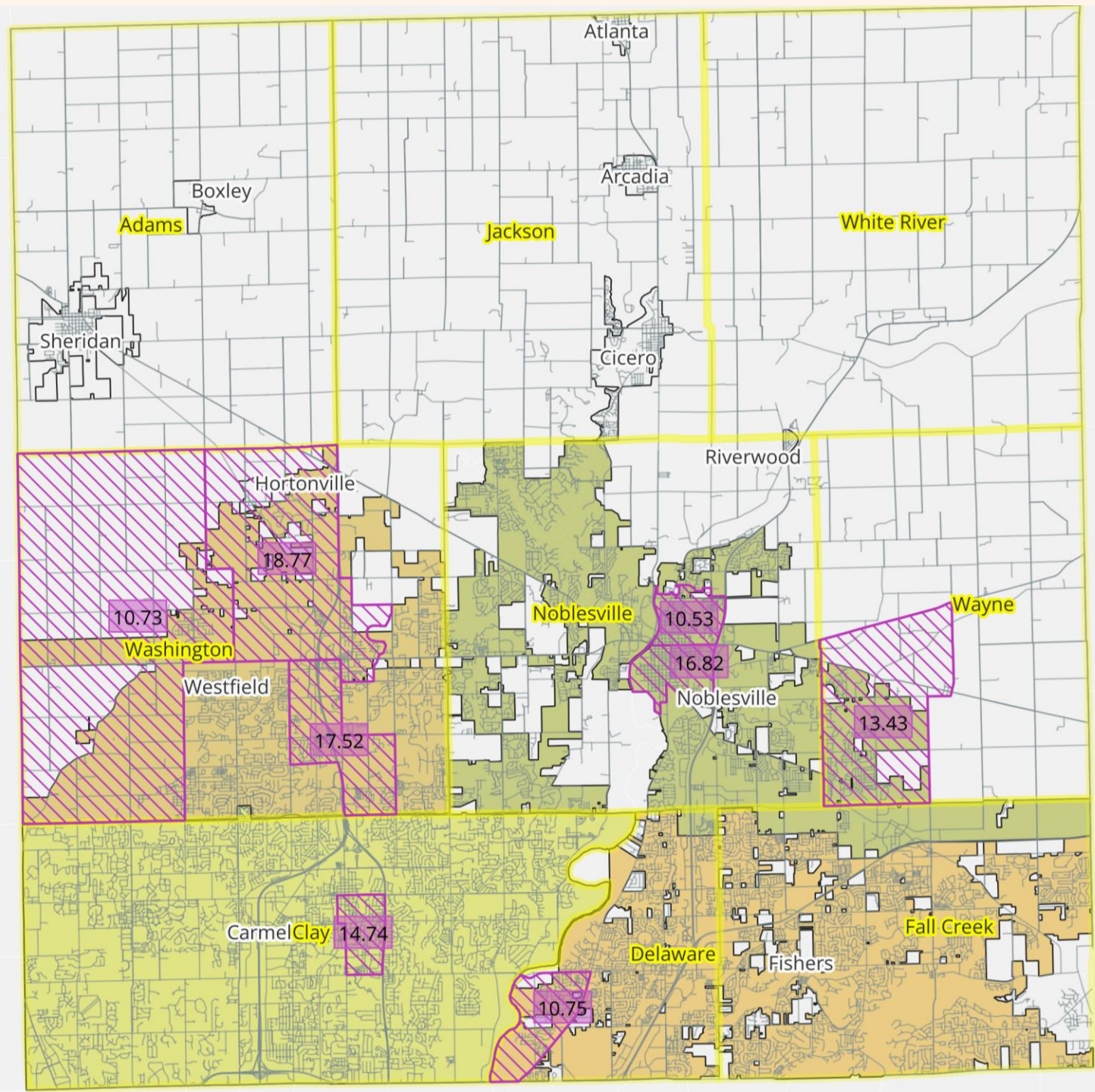

HAMILTON COUNTY DATA

Hamilton County: Households by Income and Tenure

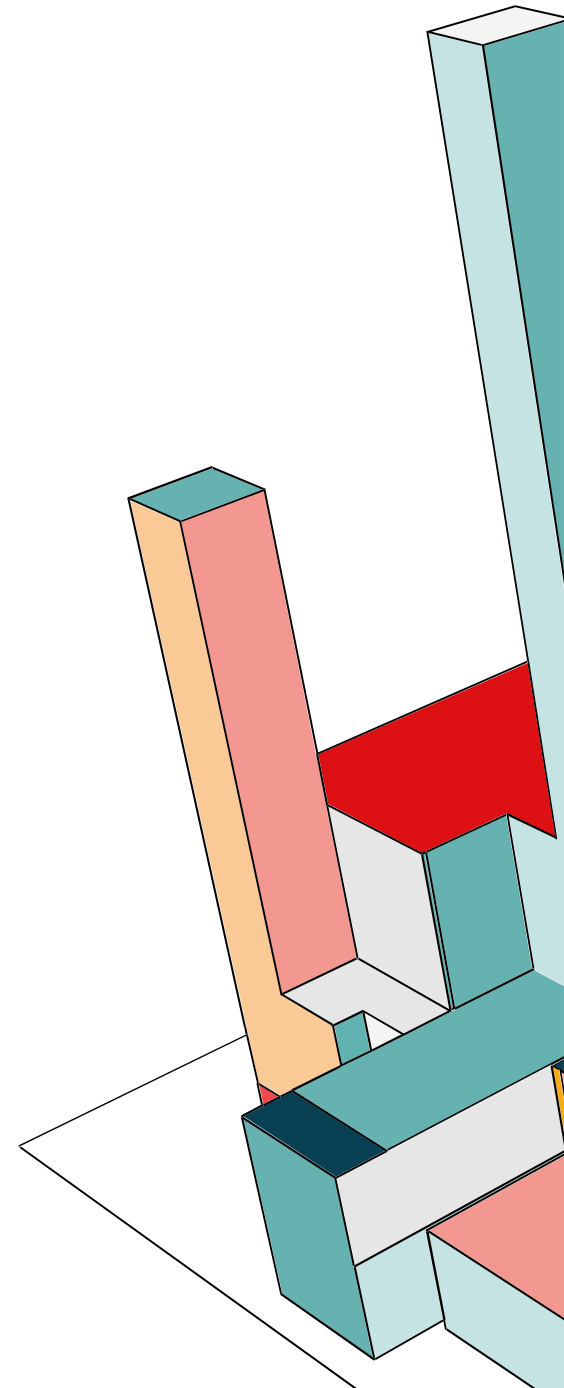

WHAT SHOULD THE FUNDS PRIORITIZE?

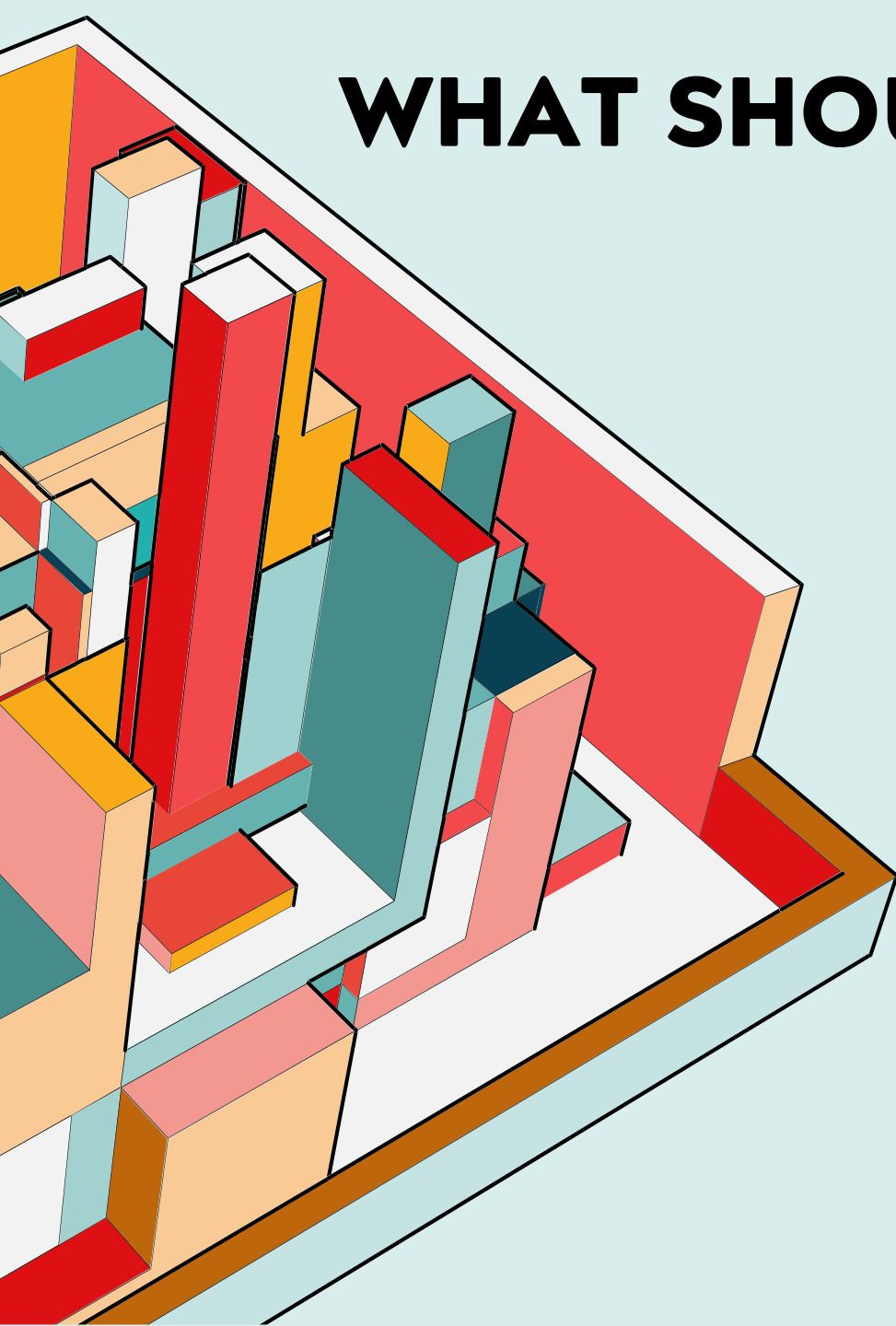

- By Category
 - Housing
 - Facilities
 - Economic Development
- By Population
 - Homeless
 - Seniors, Disabled
 - Single Parents
- By Area
- By Outcome

THE “SO WHAT”: WHAT WE FOUND

***Affordable housing was identified
as the highest priority for
CDBG funding***

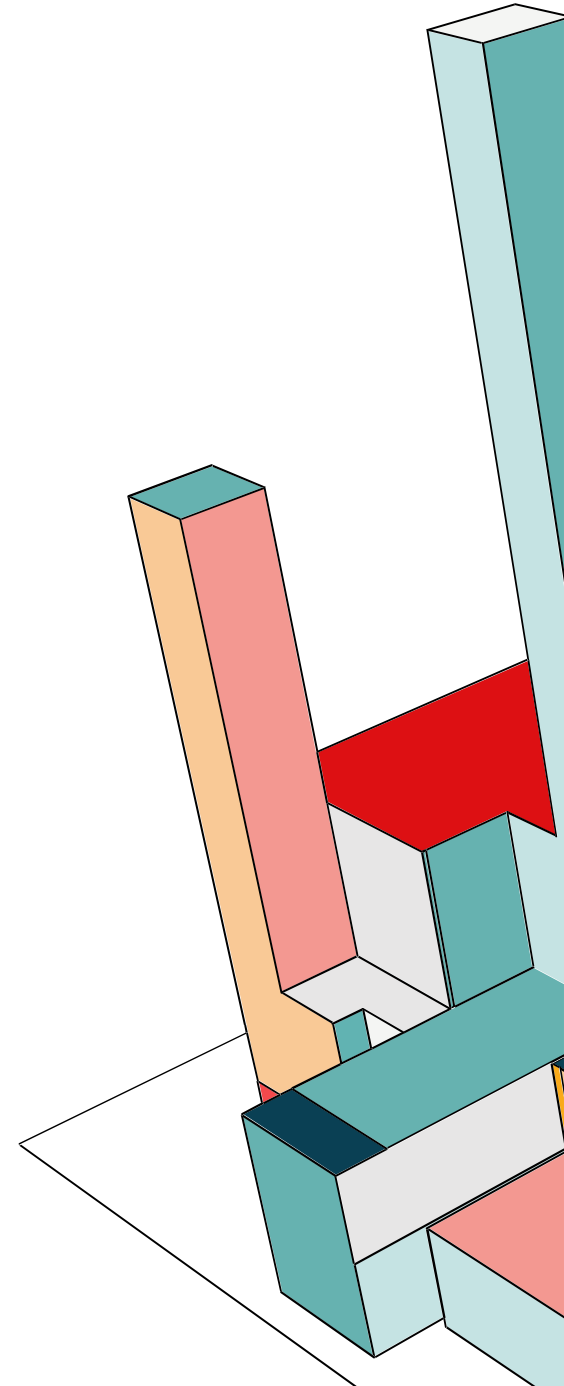

THE “SO WHAT”: WHAT WE FOUND

*City and Town Governments can
and would like to do more to
support affordable housing.*

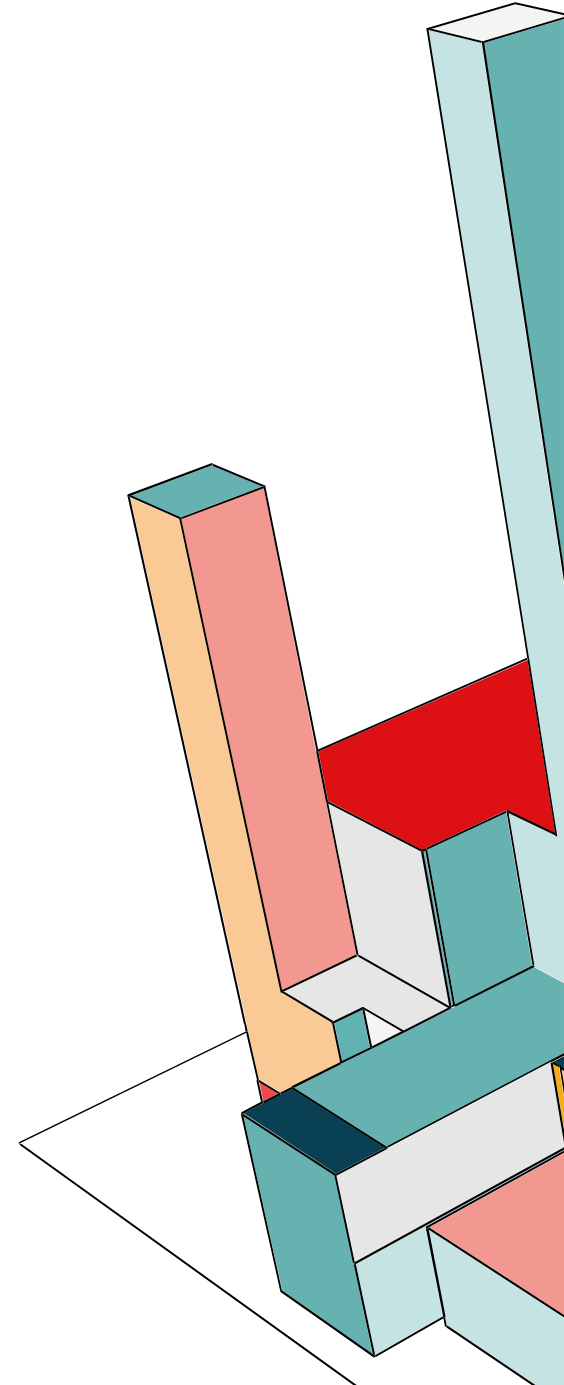

THE “SO WHAT”: WHAT WE FOUND

***There is a need for more consistency
across the County regarding the
affordable housing narrative.***

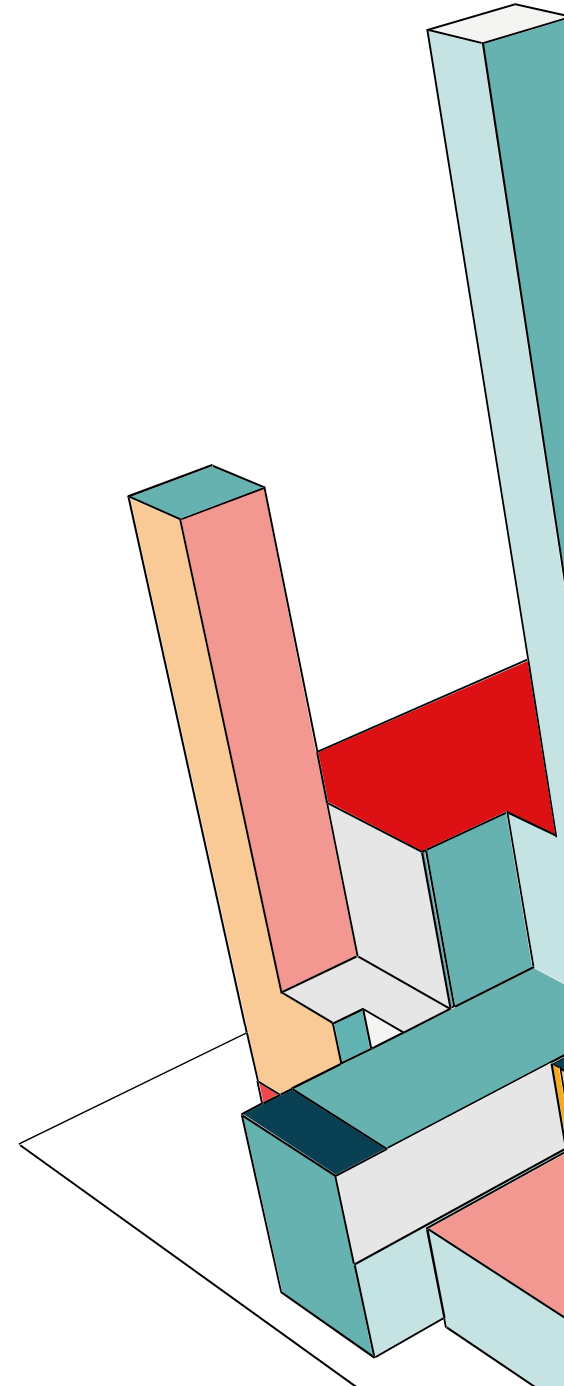

THE “SO WHAT”: WHAT WE FOUND

The amount of available funding is small compared to the need(s).

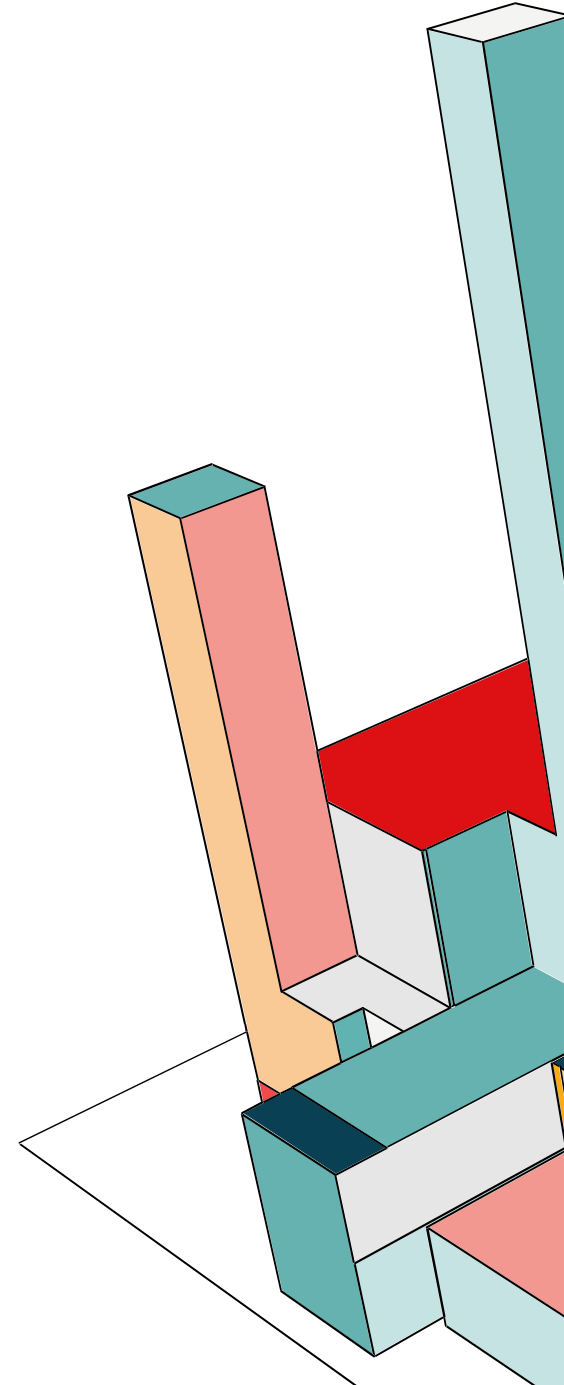

THE “SO WHAT”: WHAT WE FOUND

There are best practices across the County that can be replicated.

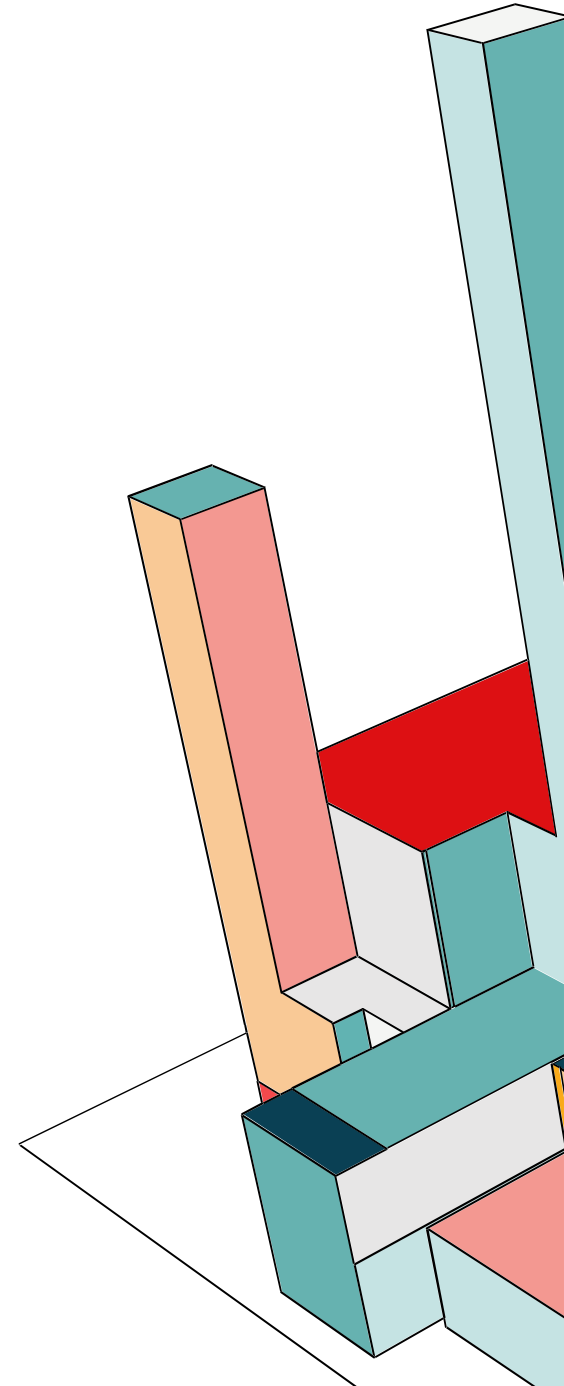

WHAT'S NEXT?

TENTATIVE SCHEDULE

- Now through end of May: Data Collection and Consultations
- June: Plan Review, Public Hearings and Comment Periods
- July: Final County Review
- August 15: Submit Plan to HUD
- October 01: Start of New Program Year and Consolidated Plan
- December: Annual Performance Report

CALL TO ACTION

Complete Survey

Additional Consultation

- Fair Housing Plan
- Public Comment on Draft Plan
- Public Comment at Public Hearing
- Additional Opportunities after Submission of Plan (Annual Performance Report)

Create Partnerships

- BE aware
- Define Roles



THANK YOU

Noblesville Housing Authority

Aimee Jacobsen

Ajacobsen@gonha.org

Michelle Westermeier

Michelle@gonha.org

Prosperity Indiana

Marie Beason

mbeason@prosperityindiana.org

Usona Development LLC

Bill Kubal

bkubal@usonadevelopment.com

